

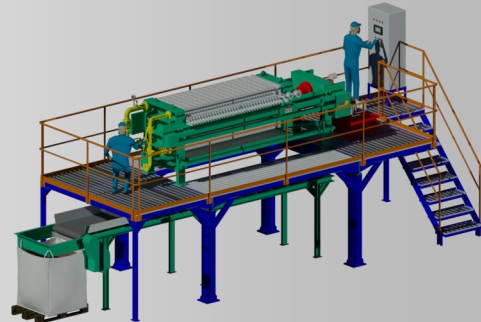

**Quality Ball, Pebble and Rod
Mills Since 1932**



**Filtration Consulting
50 years,
*Mining, Industrial, Waste
Water, Chemicals, Petro
Chemicals, Industrial***

Products and Services

- Grinding Mills: Ball, Pebble and Rod
- 3 FT (0.9 M) to 8 FT (2.44 M) dia.
- Continuous Feed
- Overflow and Grate Discharge
- Wet and Dry Grinding
- Mineral and Chemical Applications
- Consulting
- Installation Supervision and Training
- Used Equipment Inspections

Filtration Services

- Consulting Services
 - * Equipment Design
 - * Trouble Shooting
 - * Testing Evaluations
 - * Sizing
 - * Flow Sheet Development
 - * Used Equipment Inspections
- Installation Supervision and Training
- Used Equipment Inspections

To contact us:

Headquarters:
Neumann Machinery Co.
7043 S Aerie Hill Drive
West Jordan, Utah, USA 84081

Phone: 801-282-3510
Fax: 801-282-3510
E-mail: nmc@neumannmachinery.com



Ball, Pebble and Rod Mills

NEUMANN MACHINERY CO. was founded in 1984 with the acquisition of the EIMCO ball, pebble and rod mill product lines.

The company is headquartered in West Jordan, UT. USA just 14 miles south of Salt Lake City. The area is steeped in a rich history in the supply of mining and heavy industrial machinery.

NMC has taken advantage of the local resources to combine highly experienced engineering , manufacturing and service techniques.

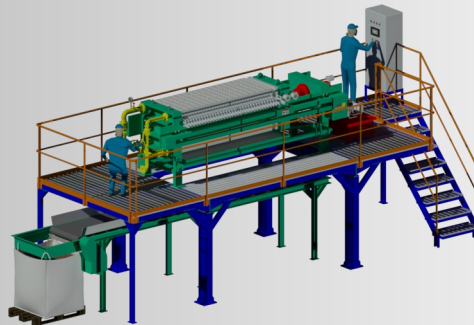

Filtration Consulting Services are Now Available.

2024, NMC makes available 50 years of experience related to all aspects of Filter Press technologies in many divers applications.

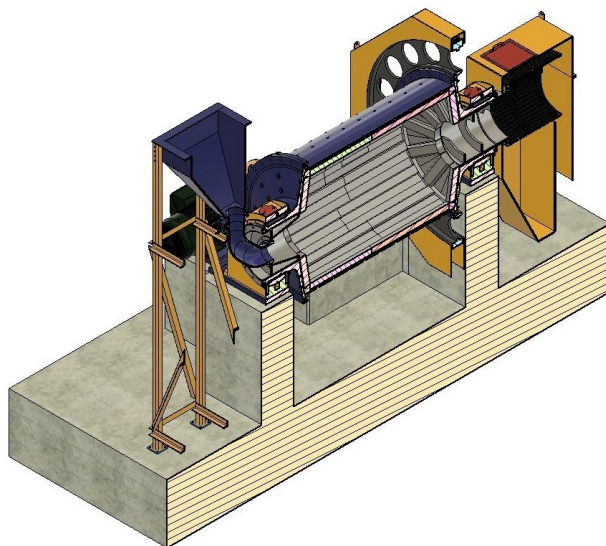
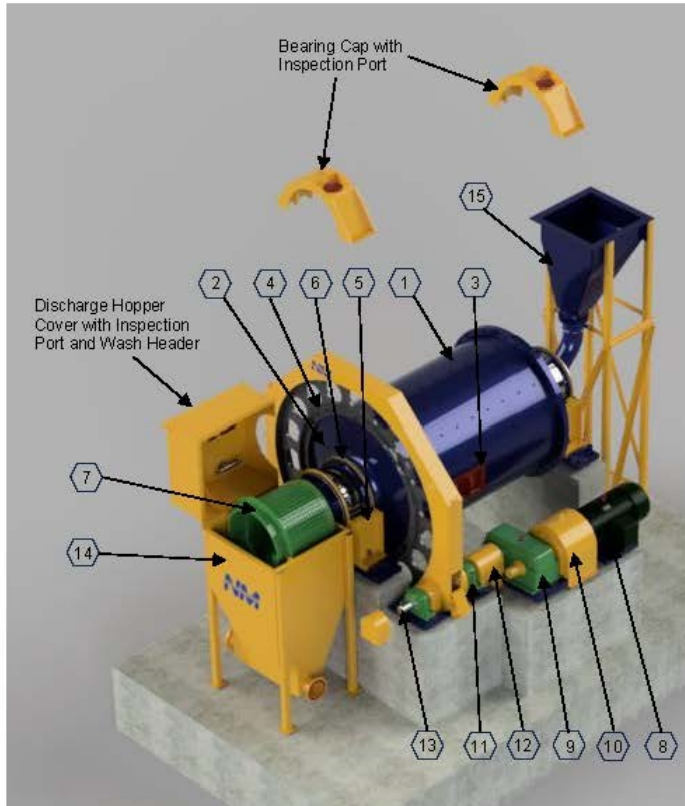

MILL FEATURES 6 FT DIA AND UP

1. Mill Shell – Steel
2. Mill Head – Ductile Iron or Cast Steel
3. Manway – Steel
4. Ring Gear and Pinion– Steel
5. Main Bearing – Hydrodynamic Journal
6. Main Bearing Seals – Felt
7. Discharge Trommel – Poly Elastomer with Steel Reinforcement
8. Motor
9. Motor to Gear Box Coupling (not shown) – Ridged for Soft Starters or Fluid.
10. Helical Gear Box
11. Pinion Shaft Bearing – Double Row Spherical
12. Gear Box to Pinion Shaft Coupling – Ridged or Air Clutch
13. Inching Drive Connection. Brake can be Incorporated.
14. Dual Compartment Discharge Hopper with Spray Header – Steel. Lined or Unlined
15. Feed Hopper and Spout – Steel. Lined or Unlined. C.I. Spout Available.

Also Available

- Main Bearing Hydrodynamic Oil Lube System
- Gear Spray Lube System
- Pinion Shaft Lube System
- Control Panel
- Inching Drive
- Mill Lifting Saddle with Jacks.
- Load Cells

- Custom arrangements available.

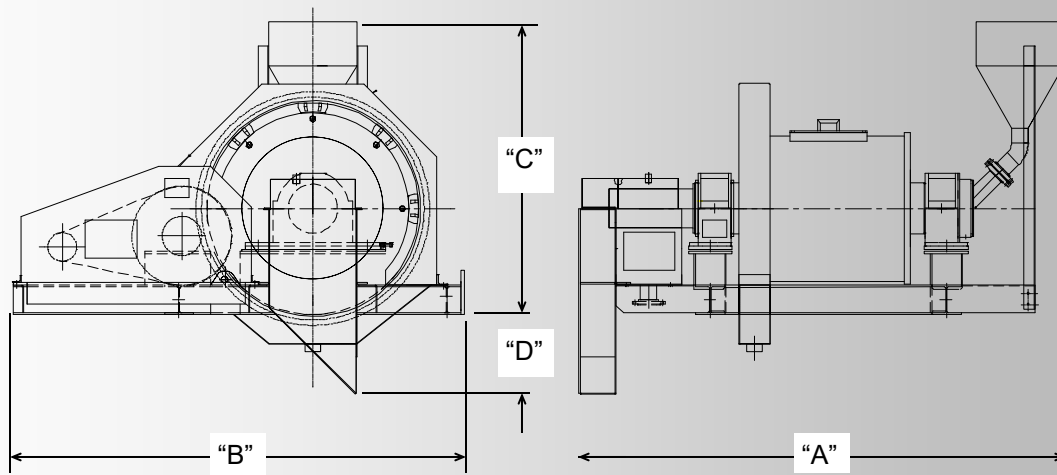

STANDARD SKID MOUNTED

Mill Size Dia x Length ft (m)	Dimensions Inches (mm) *				Wt. w/o Grinding Balls or Pulp Lb (kg)
	"A" **	"B"	"C"	"D"	
3x3 (0.9x0.9)	134 (3404)	124 (3150)	63 (1600)	22 (559)	11900 (5400)
3x4 (0.9x1.22)	146 (3708)	124 (3150)	63 (1600)	22 (559)	12720 (5770)
3x5 (0.9x1.52)	158 (4013)	124 (3150)	63 (1600)	22 (559)	13640 (6190)
3x6 (0.9x1.83)	170 (4318)	124 (3150)	63 (1600)	22 (559)	15360 (6967)
4X4 (1.22x1.22)	150 (3810)	160 (4064)	78 (1981)	52 (1320)	21200 (9620)
4X6 (1.22x1.83)	174 (4420)	160 (4064)	78 (1981)	52 (1320)	21980 (9970)
4X8 (1.22x2.44)	198 (5030)	160 (4064)	78 (1981)	52 (1320)	23120 (10500)
5X6 (1.52x1.83)	166 (4216)	196 (4980)	95 (2413)	72 (1829)	38500 (17463)
5X8 (1.52x2.44)	190 (4826)	196 (4980)	95 (2413)	72 (1829)	43500 (19730)
5X10 1.52x3.0)	214 (5436)	196 (4980)	95 (2413)	72 (1829)	49500 (22450)

*Dimensions are approximate, ** Add 10 inches (254 mm) to dimension "A" for grate discharge

- Custom arrangements available.
- Direct drive or belt drive 5 ft dia and up.
- Mill sizes up to 8 ft (2.44 m) diameter available.